



ELECTRIC SUBMERSIBLE PUMPS

Models S2C3 (A) 115V 1P, S2D3 (A) 115V 1P & S1 1/2A 115V 1P

- **Gray Iron Construction**
- **Built-in Carry Handle**
- **Motors are 115vac, Single Phase and Include a 50 ft. Power Cord**
- **Thermal Overload Protected**
- **Built-in Stainless Steel Strainer**
- **Maximum Liquid Temperature 122° F**
- **Maximum Flow is 97 GPM**
- **Optional Level Control**
- **Buna-N Mechanical Seal with Carbon and Ceramic Faces (S2C3, S1 1/2A3)**
- **Buna-N Mechanical Seal with Bronze and Steel Faces (S2D3 only)**

PREMIUM HEAVY DUTY



Model S1 1/2A3



Model S2D3

Gorman-Rupp Submersible pumps are well suited for pumping out flooded basements, pools, spas, ponds, pits, or anywhere else where the pump can be lowered into the water. The 50-foot power cord allows the pump to be lowered into areas a self-priming pump with a Suction hose could not readily access. Cast Iron construction and double mechanical seal for long life and dependability.

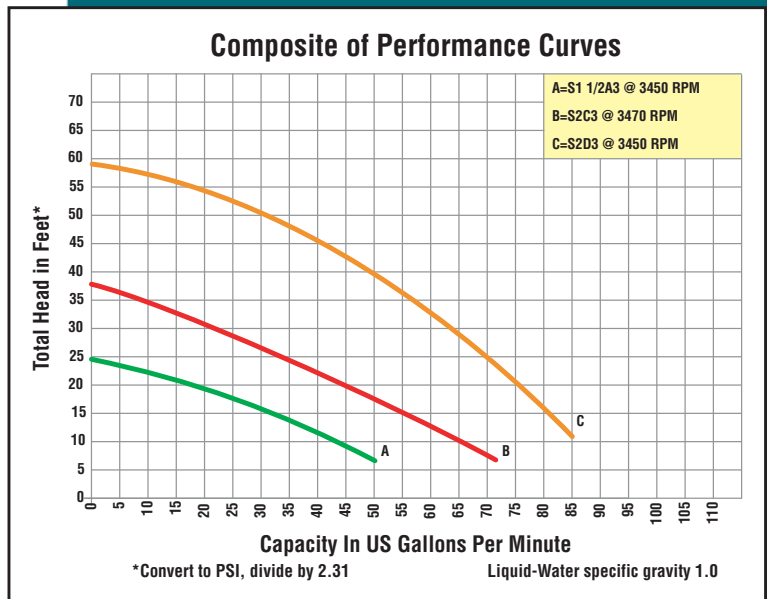

ELECTRIC SUBMERSIBLE PUMPS

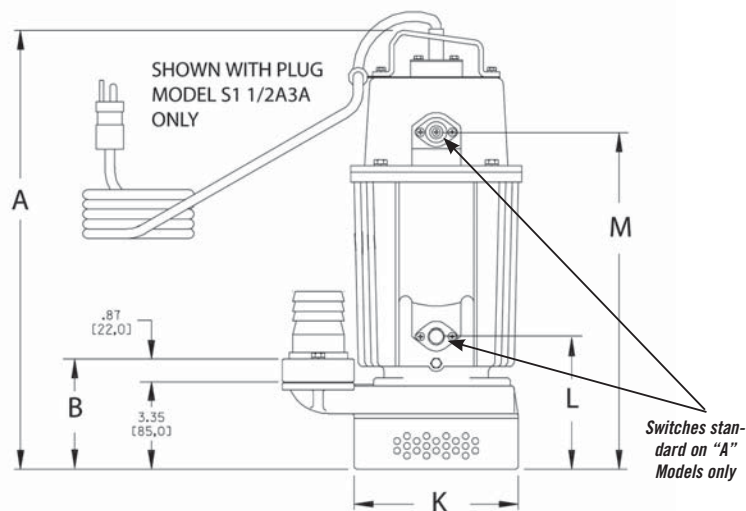
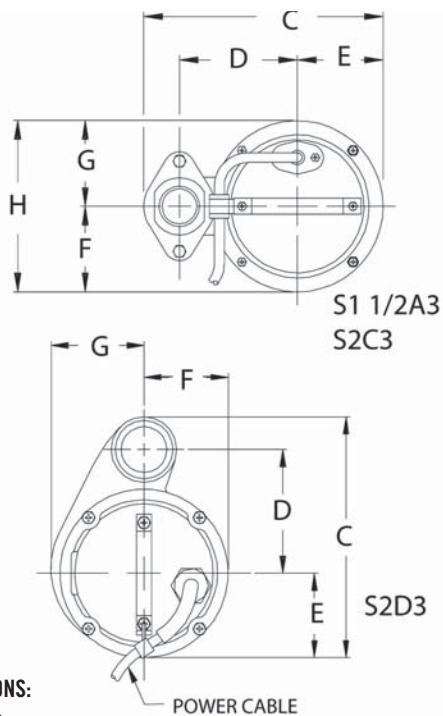

DIMENSIONS:
INCHES

(MILLIMETERS)

MODEL	A	B	C	D	E	F	G	H	DIS.	J CABLE LENGTH	K SUCTION STRAINER	L***	M**
S1 1/2A3	16.81	4.21	9.19	4.53	3.29	3.29	3.29	6.57	1.50**	50.00 FT/ [15 M]	6.30	6.00	6.00
	[427.1]	[107.0]	[233.5]	[115.0]	[83.5]	[83.5]	[83.5]	[169.0]					
S2C3	16.81	4.21	9.19	4.53	3.29	3.29	3.29	6.57	2.00*	50.00 FT/ [15 M]	6.30	6.00	6.00
	[427.1]	[107.0]	[233.5]	[115.0]	[83.5]	[83.5]	[83.5]	[169.0]					
S2D3	20.93	4.21	10.12	5.20	3.54	3.54	3.78	0.00	2.00*	50.00 FT/ [15 M]	7.09	7.50	7.50
	[531.5]	[107.0]	[257.0]	[132.0]	[90.9]	[90.9]	[96.0]	[180.0]					

(**) S1 1/2A3A ONLY (TURN ON LEVEL). (***) S1 1/2A3A ONLY (TURN OFF LEVEL)

Standard Features:

- Gray Iron construction
- Gray Iron impeller
- 50 ft. insulated conductor cable
- Stainless Steel hardware
- Built-in carry handle
- 1-1/2" NPT Discharge
- Stainless Steel strainer
- Buna-N mechanical seal with carbon and ceramic faces
- Thermal overload protected
- Built in liquid level control on (A) models
- Bronze and steel faces (S2D3)
- Maximum liquid temperature 122° F
- Maximum flow 87 GPM
- Optional level control 90° wide angle with float switch #27471-192
- "Off-the-Shelf" availability

*Requires attaching a standard 115V plug (not supplied) S2C3 & S2D3

MODEL	DESCRIPTION/ TYPE OF PUMP	SHIP WT.	DRIVER TYPE & HP	PORT SIZE SUC. X DIS. (NPT)	BASIC CONSTRUCTION	SEAL TYPE & ELASTOMER/ FACES	VAC	FULL LOAD AMPS	MOTOR ENCLOSURE
S1 1/2 A3 (A)	Electric Submersible Pumps	42 lbs.	Elect. Motor 1/3 hp	1.5"	Gray Iron	Buna/Carbon/Ceramic	115V	4.8	Gray Iron
S2C3 (A)	Electric Submersible Pumps	52 lbs.	Elect. Motor 1/2 hp	2"	Gray Iron	Buna/Carbon/Ceramic	115V	6.8	Gray Iron
S2D3 (A)	Electric Submersible Pumps	78 lbs.	Elect. Motor 1 hp	2"	Gray Iron	Buna/Bronze/Steel	115V	9.0	Gray Iron



See price book page 41

The Gorman-Rupp Company reserves the right to discontinue any model or change specifications at any time without incurring any obligation.

CP105-106/1206